

DESCRIPTION

Solenoid 3 way
Direct acting poppet type

CONSTRUCTION

Body	Stainless Steel
Armature tube	Stainless Steel
Armature & core	Stainless Steel
Spring	Stainless Steel
Seal	NBR FPM EPDM

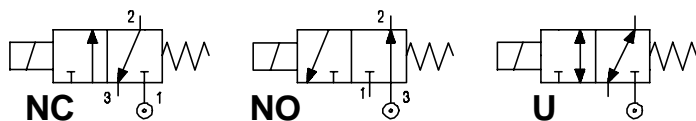
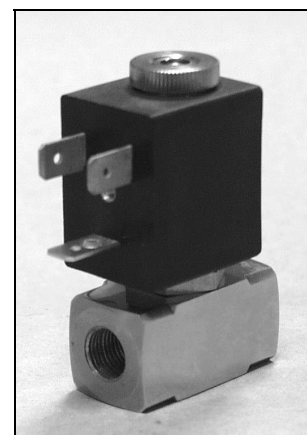

3

FEATURES

Maximum allowable pressure 30 bar
 Maximum fluid viscosity 25cSt (mm²/s)
 Ambient temperature : with class F coil -10° +55°C
 with class H coil -10°+80°C
 Universal mounting position

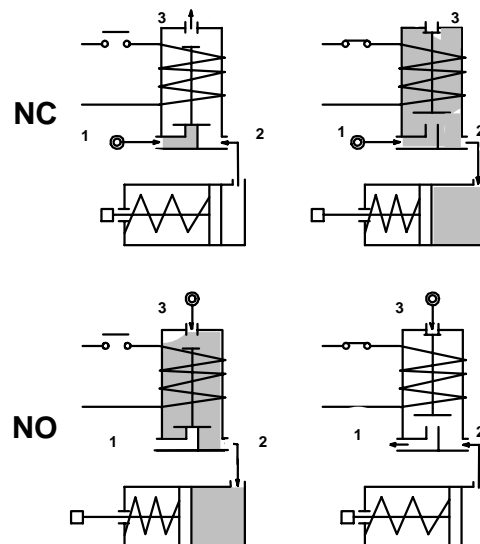

OPTIONS : Silver shading ring
 Explosion proof coil to EExmIIT4 Type 7
 Exhaust with hosetail connection

CODE ① ②	Connection G	Orifice mm		KV m ³ /h	Differential Pressure bar			Nominal Power			Coil		Seal ①	Temp. range C°
		inlet	EXHAUST		Min	Max		AC Inrush	VA Holding	DC Watt	Type	Width		
						AC	DC							
NC Normally closed														
E311A.....12///.....	1/8"	1.2	1.5	0.04	0	15	15	12	8	6.5	3	22	NBR=B EPDM=E FPM=V	-10 +90 <+140 -10 +130
E311A.....15///.....	1/8"	1.5	1.7	0.06	0	10	10	12	8	6.5	3	22		
E311A.....20///.....	1/8"	2	1.7	0.09	0	6	6	12	8	6.5	3	22		
NO Normally open														
E311A.....15/S/.....	1/8"	1.5	1.5	0.06	0	10	10	12	8	6.5	3	22	NBR=B EPDM=E FPM=V	-10 +90 <+140 -10 +130
E311A.....17/S/.....	1/8"	1.7	2	0.07	0	6	6	12	8	6.5	3	22		
U Universal														
E311A.....15/G/.....	1/8"	1.5	1.5	0.06	0	6	6	12	8	6.5	3	22		

3.311.A/01/02

① Seal
 ② Coil

Example E311AV15///30B FPM Seal 24V 50Hz NC
 E311 AB15/S/301 NBR Seal 24V DC NO

COIL	Alternating Current ~50 /60Hz Volt							Direct current Volt			Electrical connection	Connector
	12	24	48	110	220 230	240	380	12	24	48		
Type 3 Width 22 Code ②	30A	30B	30C	30D	30E	30F	30G	300	301	302	DIN 46244	PG9 code 10348000

DESCRIPTION
 Class F insulation
 Voltage tolerance
 AC +15% -10%
 DC ± 10%
 Protection to IP65
 with connector fitted
 Continuous
 serviceED100%
OPTIONS :
 Class H insulation
 Cable attached
 Special coil voltage
 Special coil powers

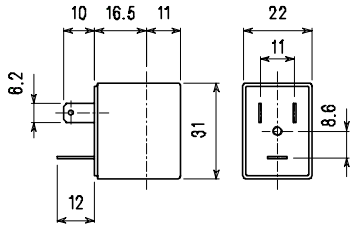
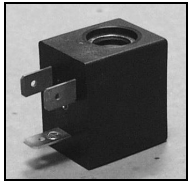

Type 3 Weight 0.05Kg

SPARE PARTS LIST

- 1.Coil fixing nut
- 2.Coil
- 3.Armature assembly
- 4.Armature tube with core

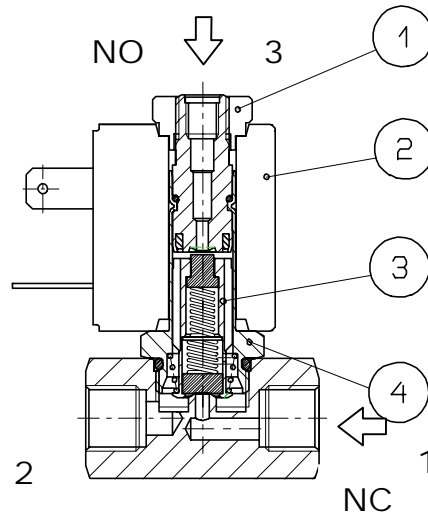

OVERALL DIMENSION

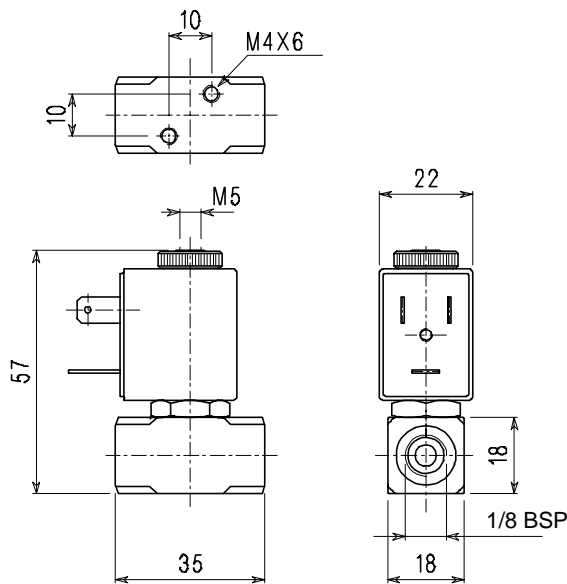

Weight 0.15 Kg